

KISI LITE

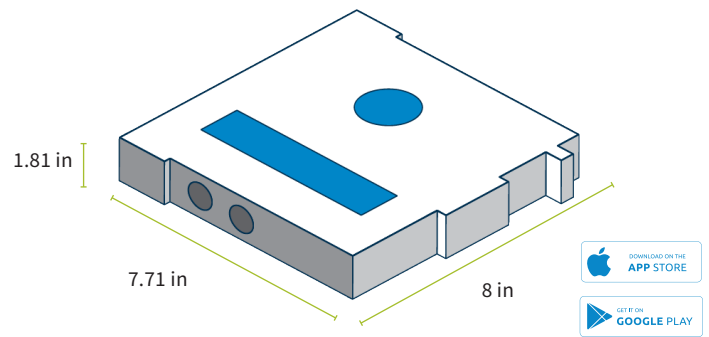

HARDWARE

- Universal mounting pattern
- Outer mounting holes for proper gasket seal
- Enclosure is rain tight when mounted vertically
- Enclosure can be secured with a padlock

ELECTRONICS

Capabilities

- Compatible with existing access control panel
- Capable of 4 access points per device using dry contact
- Wireless Wifi configuration
- 4G connectivity optional
- Including USB power adapter with US plug (5V, 1A)

WIRING

Fail Safe - Wire the signal normally closed.

Fail Secure - Wire the signal normally open.

CERTIFICATIONS

- FCC Certification (US),
- CE1471 (EU),
- IC C-Tick Modular Certification
- Radio Law - MIC (Japan)

Back View

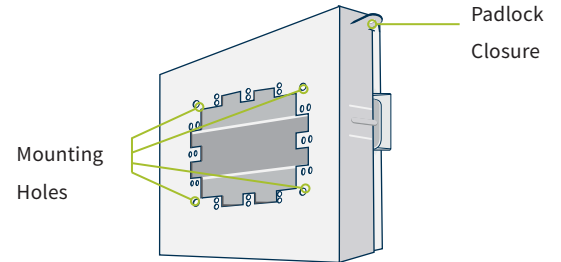

PCB

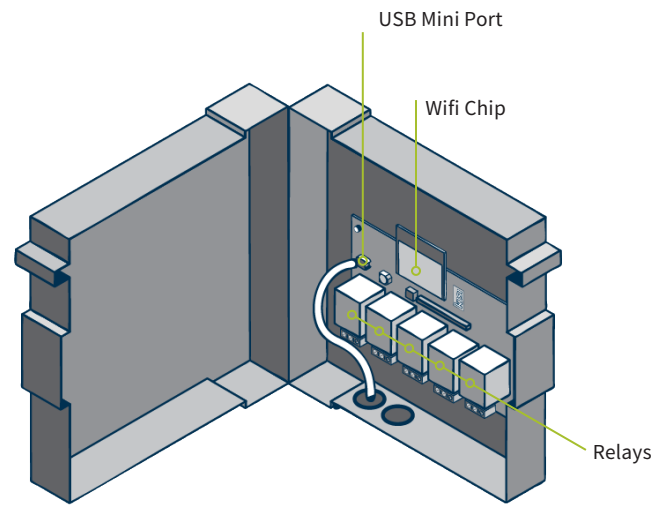

Wiring Diagram

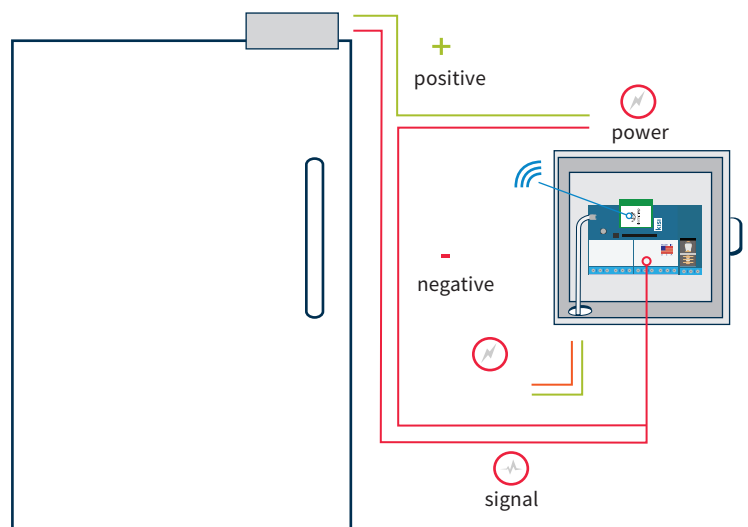

 Your existing keycard/intercom system still works!

 Made in Brooklyn

Engineered in Germany